

NOW LEASING

HIGH PROFILE RETAIL SPACE AVAILABLE
MINUTES FROM DOWNTOWN PENTICTON



285 WESTMINSTER AVENUE W
PENTICTON, BC



SITE PLAN & AVAILABLE SPACE

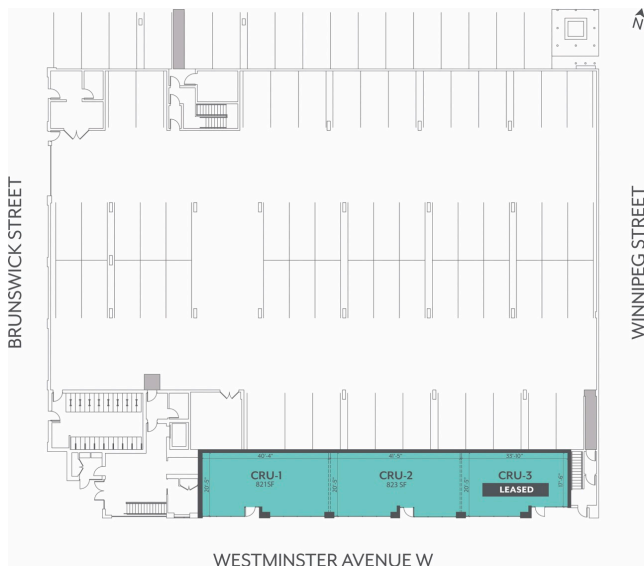

**Units can be made contiguous*

PROPERTY DETAILS

CIVIC ADDRESS	285 Westminister Ave. W, Penticton, BC
LOCATION	Minutes from downtown Penticton, these retail units are incorporated into a brand-new rental community at 285 Westminister Avenue.
AVAILABLE SPACE	CRU 1 – 821 SF* CRU 2 – 823 SF* CRU 3 – 691 SF* - LEASED *Units can be made contiguous
HIGHLIGHTS	<ul style="list-style-type: none"> • High profile units of up to 2,377 SF • Prominent frontage on pedestrian-friendly Westminister Avenue • High exposure location with high traffic counts, minutes from downtown Penticton and from the beach • Surrounded by a host of restaurants, cafés, and pubs • Multiple sizes and configurations available
BUILDING AMENITIES	<ul style="list-style-type: none"> • Street Level Retail & Restaurant Space (+/- 2,377 SF) • Built, Owned, and Professionally Managed by Mission Group
OPPORTUNITY	High profile units from 680 SF up to 2,377 SF, with available demising options.
ADDITIONAL RENT	\$10.62 per SF est. 2022
LEASE RATE	Please contact Mission Group Commercial Leasing on 250.317.6998 or mgleasing@missiongroup.ca

NEIGHBOURHOOD MAP

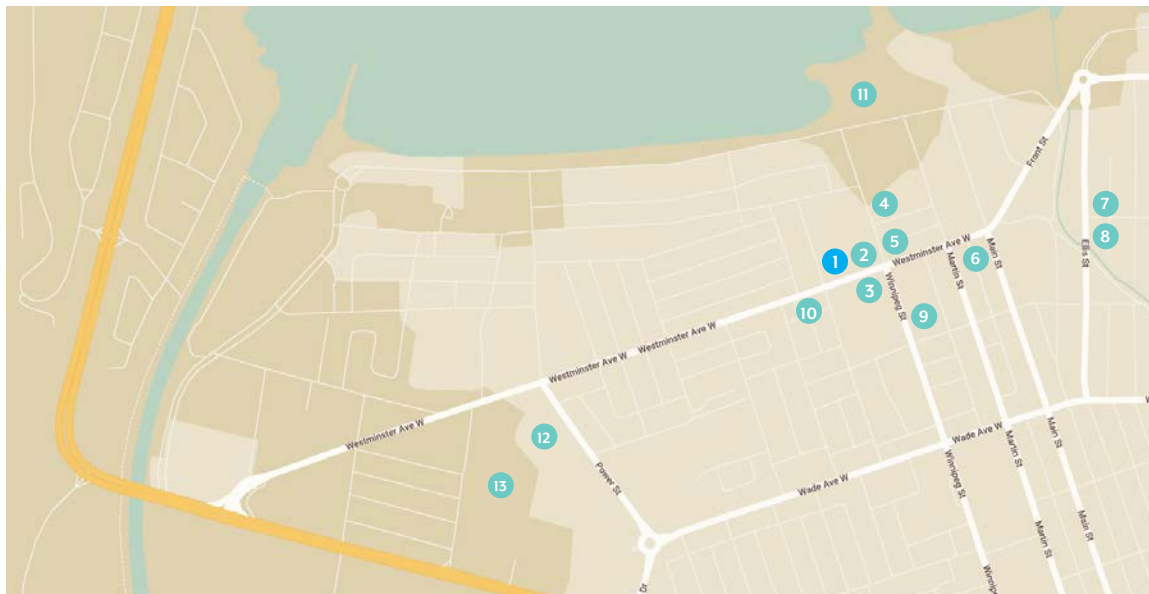

- 1 285 Westminister Ave. W
- 2 Wayne & Freda
- 3 The Black Antler
- 4 Bad Tattoo Brewing
- 5 Neighbourhood Brewing
- 6 Slackwater Brewing
- 7 Cannery Brewing
- 8 Highway 97 Brewing
- 9 Landmark Cinemas Penticton
- 10 Bike Barn
- 11 Okanagan Lake Beach
- 12 Penticton Trade and Convention Centre
- 13 South Okanagan Events Centre

 **8,124**
population within
4km radius

 **\$86,100**
Average Household Income
(population within 2km radius)

 **1.2 MILLION**
visitors to Penticton, annually

 **49**
average age of
population in this area

 **7,000**
daily average vehicle count
for Westminister Ave



www.missiongroup.ca

LEASING INQUIRIES CONTACT INFORMATION

Christopher Rundle
Commercial Leasing Manager, Mission Group
250.317.6998
mgleasing@missiongroup.ca