

# NOW LEASING

HIGH PROFILE RETAIL SPACE AVAILABLE  
MINUTES FROM DOWNTOWN PENTICTON



285 WESTMINSTER AVENUE W  
PENTICTON, BC



MISSION  
GROUP

## SITE PLAN & AVAILABLE SPACE

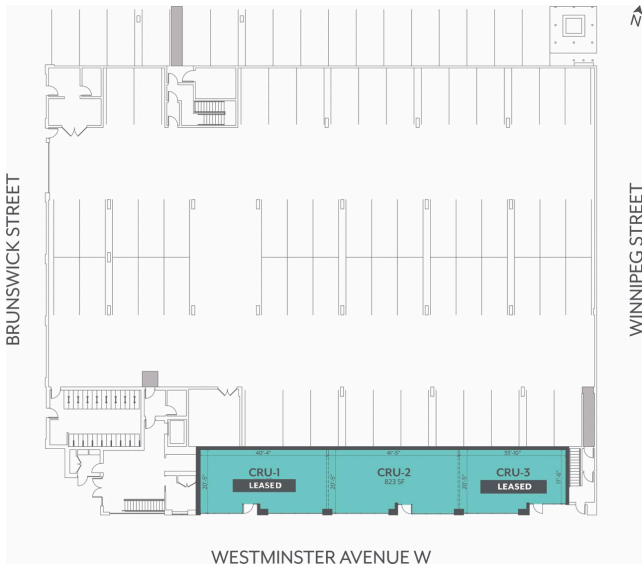

## PROPERTY DETAILS

<b>CIVIC ADDRESS</b>	285 Westminister Ave. W, Penticton, BC
<b>LOCATION</b>	Minutes from downtown Penticton, these retail units are incorporated into a brand-new rental community at 285 Westminister Avenue.
<b>AVAILABLE SPACE</b>	CRU 1 – 824 SF - LEASED CRU 2 – 823 SF CRU 3 – 691 SF - LEASED
<b>HIGHLIGHTS</b>	<ul style="list-style-type: none"> <li>• High profile unit containing 823 SF</li> <li>• Prominent frontage on pedestrian-friendly Westminister Avenue</li> <li>• High exposure location with high traffic counts, minutes from downtown Penticton and from the beach</li> <li>• Surrounded by a host of restaurants, cafés, and pubs</li> </ul>
<b>BUILDING AMENITIES</b>	<ul style="list-style-type: none"> <li>• Street Level Retail &amp; Restaurant Space</li> <li>• Built, Owned, and Professionally Managed by Mission Group</li> </ul>
<b>OPPORTUNITY</b>	High profile unit 823 SF
<b>ADDITIONAL RENT</b>	\$10.62 per SF est. 2023
<b>LEASE RATE</b>	Please contact Mission Group Commercial Leasing on 250.317.6998 or <a href="mailto:mgleasing@missiongroup.ca">mgleasing@missiongroup.ca</a>

## NEIGHBOURHOOD MAP

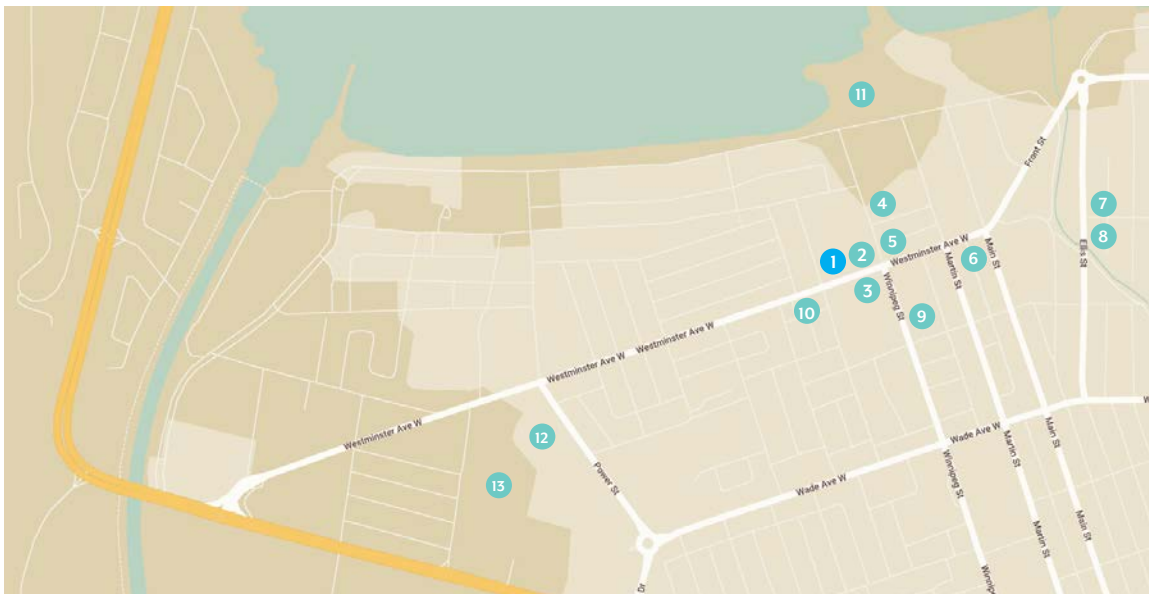

- 1 285 Westminister Ave. W
- 2 Wayne & Freda
- 3 The Black Antler
- 4 Bad Tattoo Brewing
- 5 Neighbourhood Brewing
- 6 Slackwater Brewing
- 7 Cannery Brewing
- 8 Highway 97 Brewing
- 9 Landmark Cinemas Penticton
- 10 Bike Barn
- 11 Okanagan Lake Beach
- 12 Penticton Trade and Convention Centre
- 13 South Okanagan Events Centre

**8,124**  
population within  
4km radius

**\$86,100**  
Average Household Income  
(population within 2km radius)

**1.2 MILLION**  
visitors to Penticton, annually

**49**  
average age of  
population in this area

**7,000**  
daily average vehicle count  
for Westminister Ave



[www.missiongroup.ca](http://www.missiongroup.ca)

## LEASING INQUIRIES CONTACT INFORMATION

**Christopher Rundle**  
Commercial Leasing Manager, Mission Group  
250.317.6998  
[mgleasing@missiongroup.ca](mailto:mgleasing@missiongroup.ca)