

NOW LEASING

HIGH PROFILE RETAIL SPACE AVAILABLE
MINUTES FROM DOWNTOWN PENTICTON



285 WESTMINSTER AVENUE W
PENTICTON, BC



SITE PLAN & AVAILABLE SPACE

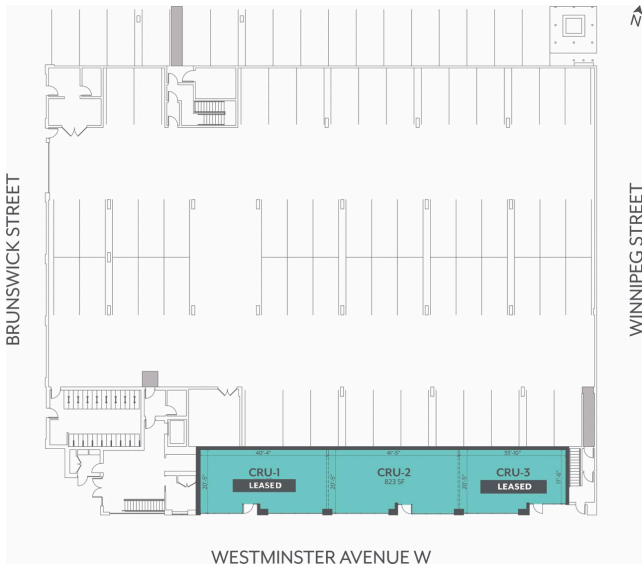

PROPERTY DETAILS

CIVIC ADDRESS	285 Westminister Ave. W, Penticton, BC
LOCATION	Minutes from downtown Penticton, these retail units are incorporated into a brand-new rental community at 285 Westminister Avenue.
AVAILABLE SPACE	CRU 1 – 824 SF - LEASED CRU 2 – 823 SF CRU 3 – 691 SF - LEASED
HIGHLIGHTS	<ul style="list-style-type: none"> High profile unit containing 823 SF Prominent frontage on pedestrian-friendly Westminister Avenue High exposure location with high traffic counts, minutes from downtown Penticton and from the beach Surrounded by a host of restaurants, cafés, and pubs
BUILDING AMENITIES	<ul style="list-style-type: none"> Street Level Retail & Restaurant Space Built, Owned, and Professionally Managed by Mission Group
OPPORTUNITY	High profile unit 823 SF
ADDITIONAL RENT	\$10.68 per SF est. 2024
LEASE RATE	Please contact Mission Group Commercial Leasing on 250.317.6998 or mgleasing@missiongroup.ca

NEIGHBOURHOOD MAP

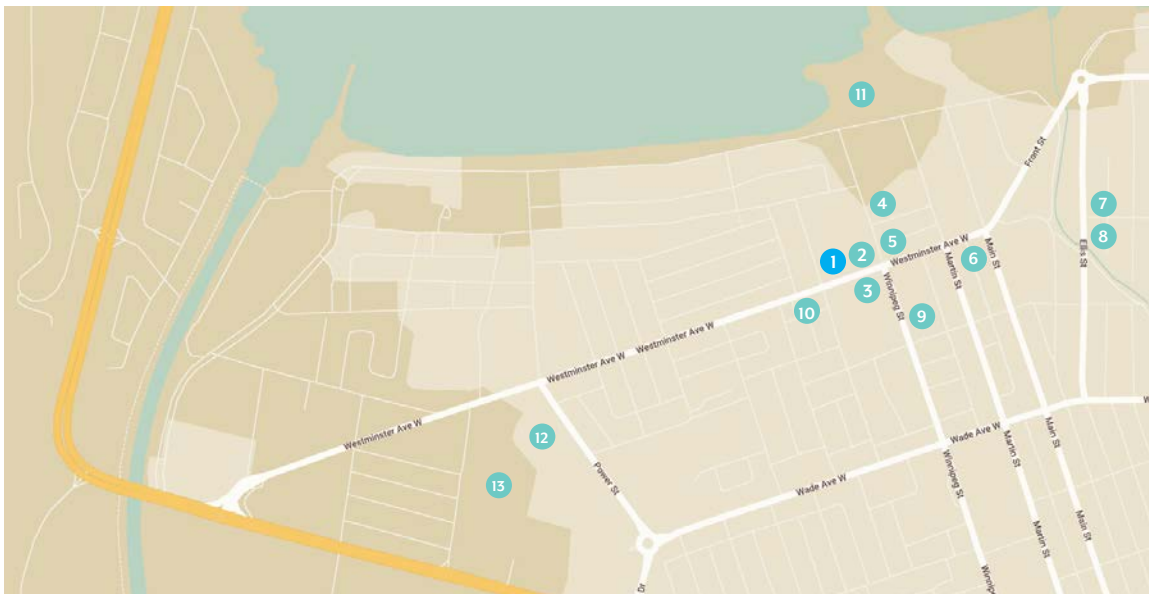

- 1 285 Westminister Ave. W
- 2 Wayne & Freda
- 3 The Black Antler
- 4 Bad Tattoo Brewing
- 5 Neighbourhood Brewing
- 6 Slackwater Brewing
- 7 Cannery Brewing
- 8 Highway 97 Brewing
- 9 Landmark Cinemas Penticton
- 10 Bike Barn
- 11 Okanagan Lake Beach
- 12 Penticton Trade and Convention Centre
- 13 South Okanagan Events Centre

8,124
population within
4km radius

\$86,100
Average Household Income
(population within 2km radius)

1.2 MILLION
visitors to Penticton, annually

49
average age of
population in this area

7,000
daily average vehicle count
for Westminister Ave



www.missiongroup.ca

LEASING INQUIRIES CONTACT INFORMATION

Christopher Rundle
Commercial Leasing Manager, Mission Group
250.317.6998
mgleasing@missiongroup.ca