

# NOW LEASING

HIGH PROFILE RETAIL SPACE AVAILABLE  
MINUTES FROM DOWNTOWN PENTICTON



285 WESTMINSTER AVENUE W  
PENTICTON, BC



## SITE PLAN & AVAILABLE SPACE

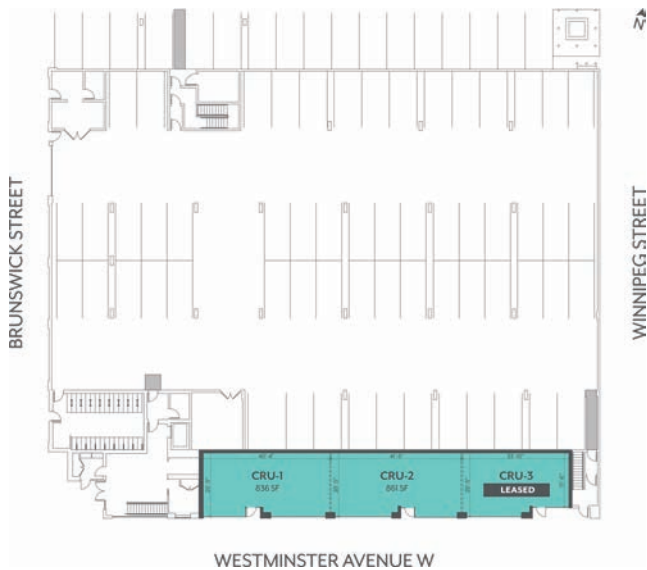

\*Units can be made contiguous

## PROPERTY DETAILS

CIVIC ADDRESS	285 Westminister Ave. W, Penticton, BC
LOCATION	Minutes from downtown Penticton, these retail units are incorporated into a brand-new rental community at 285 Westminister Avenue.
AVAILABLE SPACE	CRU 1 – 836 SF* CRU 2 – 861 SF* CRU 3 – 680 SF* - LEASED *Units can be made contiguous
HIGHLIGHTS	<ul style="list-style-type: none"> <li>High profile units of up to 2,377 SF</li> <li>Prominent frontage on pedestrian-friendly Westminister Avenue</li> <li>High exposure location with high traffic counts, minutes from downtown Penticton and from the beach</li> <li>Surrounded by a host of restaurants, cafés, and pubs</li> <li>Multiple sizes and configurations available</li> </ul>
BUILDING AMENITIES	<ul style="list-style-type: none"> <li>Street Level Retail &amp; Restaurant Space (+/- 2,377 SF)</li> <li>Built, Owned, and Professionally Managed by Mission Group</li> </ul>
OPPORTUNITY	High profile units from 680 SF up to 2,377 SF, with available demising options.
ADDITIONAL RENT	\$10.62 per SF est. 2022
LEASE RATE	Please contact Mission Group Commercial Leasing on 250.317.6998 or <a href="mailto:mgleasing@missiongroup.ca">mgleasing@missiongroup.ca</a>

## NEIGHBOURHOOD MAP

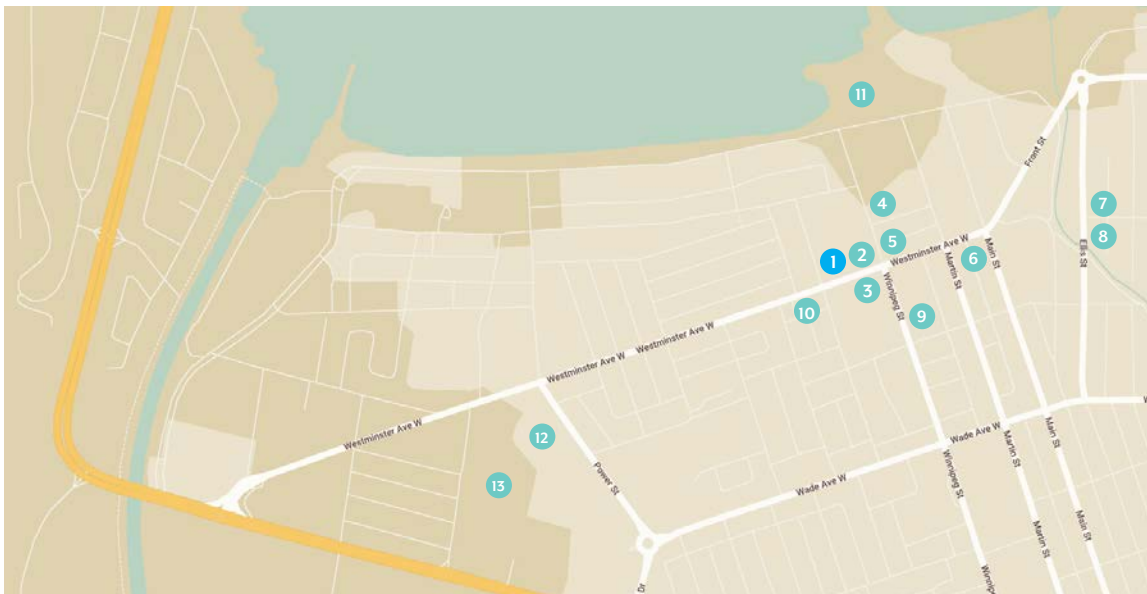

- 285 Westminister Ave. W
- Wayne & Freda
- The Black Antler
- Bad Tattoo Brewing
- Neighbourhood Brewing
- Slackwater Brewing
- Cannery Brewing
- Highway 97 Brewing
- Landmark Cinemas Penticton
- Bike Barn
- Okanagan Lake Beach
- Penticton Trade and Convention Centre
- South Okanagan Events Centre

 **8,124**  
population within  
4km radius

 **\$86,100**  
Average Household Income  
(population within 2km radius)

 **1.2 MILLION**  
visitors to Penticton, annually

 **49**  
average age of  
population in this area

 **7,000**  
daily average vehicle count  
for Westminister Ave



[www.missiongroup.ca](http://www.missiongroup.ca)

## LEASING INQUIRIES CONTACT INFORMATION

**Christopher Rundle**  
Commercial Leasing Manager, Mission Group  
250.317.6998  
[mgleasing@missiongroup.ca](mailto:mgleasing@missiongroup.ca)